

Curtis Creek Contamination Zone

Map Purpose & Description

The Curtis Creek has become contaminated by run-off and fertilizer that seeps into the water course from adjacent properties and road ways. The local conservation authority and the municipal government of East City are studying the feasibility of reclaiming the water course. The project manager has asked for a map to be prepared showing a 15 meter buffer around the water way.

Using Bentley Map V8 XM Edition, a 15 meter buffer was created around the creek using the "Create Buffer Tool" within the Map Manager.

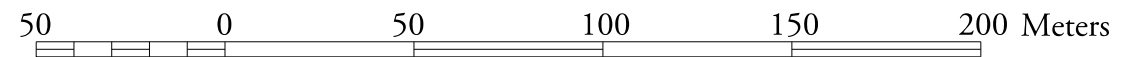
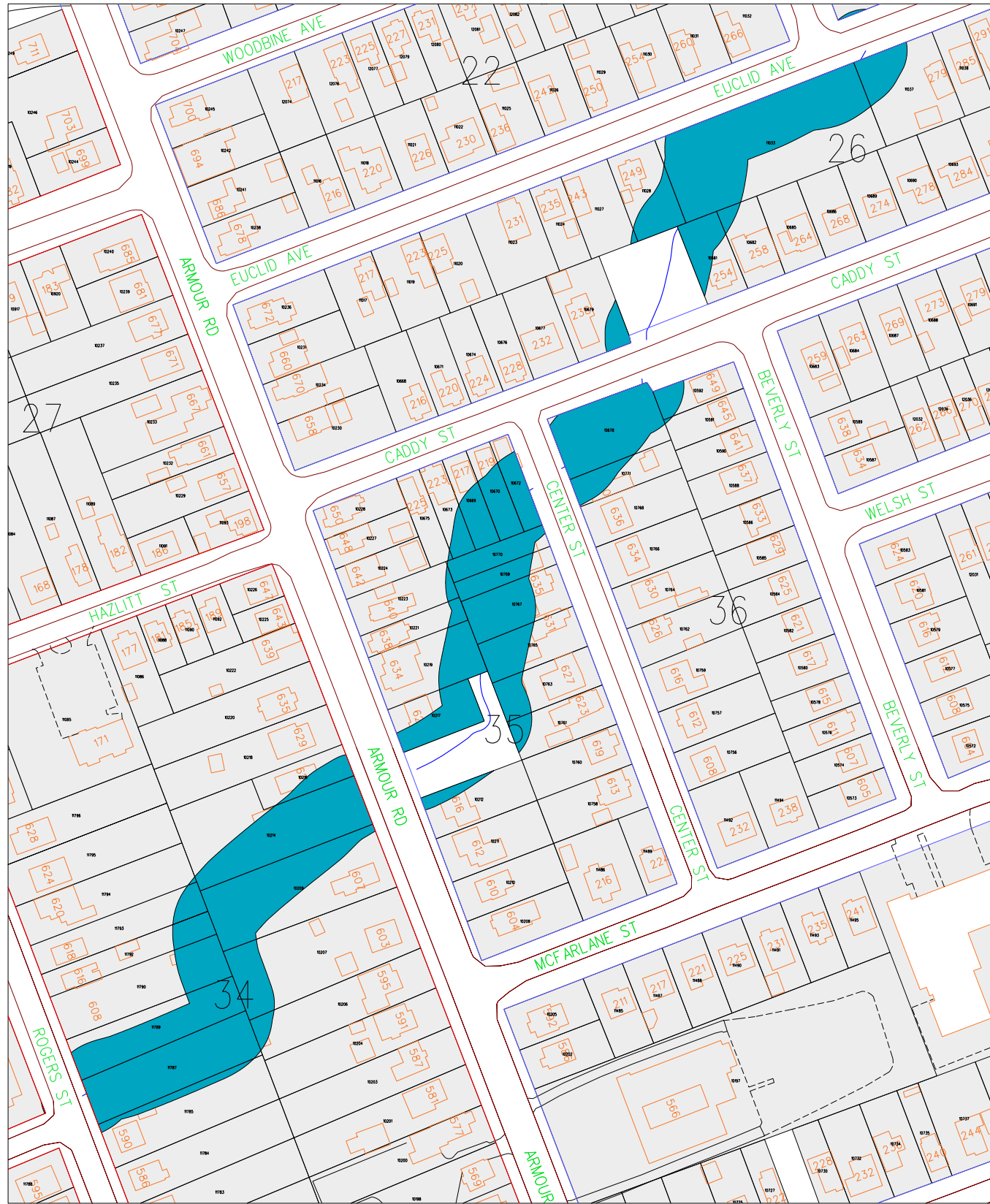

Scale: 1:2,000

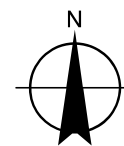

Barbara C. Pietersma
October 28, 2009
This product is unedited, unverified and intended for student training purposes only.